

SMDA-200 & SMDA-400 Individual Components

SMDA safety door drives are suitable for use in machines from a wide range of industries and can be mounted in any position. Both SMDA models are available as individual components, the SMDA-400 additionally in a box version.

In the **individual version**, the drive and control unit can be installed separately.

DRIVE

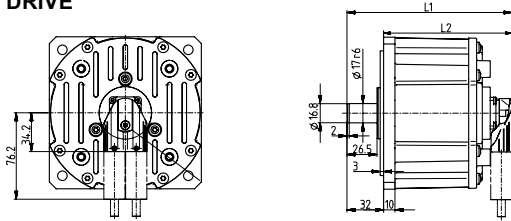

CONTROL UNIT

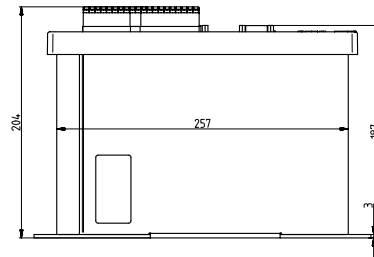
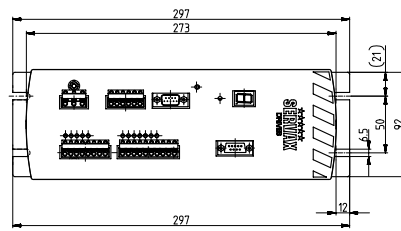

Technical Data

| Model | | SMDA-200 | SMDA-400 |
|---------------------------------|-------------------|--|---------------|
| Door weight | kg | ≤ 260 | 200 – 750 |
| Tensile force | N | 230 | 400 |
| Traverse path | m | ≤ 8.0 | ≤ 8.0 |
| Max. traverse speed | m/s | 1.0 | 1.0 |
| Motor data | | | |
| Motor technology | | 16-pole permanent magnetic direct drive | |
| Nominal motor torque | Nm | 3.1 | 5.4 |
| Motor pulse torque | Nm | 6.0 | 9.8 |
| Nominal speed at nominal torque | min ⁻¹ | 335 | 270 |
| Overall length L1 | mm | 145.5 | 169 |
| Installation depth L2 | mm | 113.5 | 137 |
| Motor weight | kg | 3.9 | 5.3 |
| Mounting position | | any | any |
| Motor voltage | VAC | 17 | 22 |
| Protection class | | IP54 | IP54 |
| Control data | | | |
| Max. power consumption | W | 190 | 310 |
| Mains voltage | VAC | 115/230/400 | 115/230/400 |
| Mains frequency | Hz | 50/60 | 50/60 |
| Ambient operating temperature | °C | + 10 ... + 40 | + 10 ... + 40 |
| Relative humidity | % | 15 ... 85 | 15 ... 85 |
| Protection class | | IP20 | IP20 |
| Digital I/O | VDC | 24 | 24 |
| Ports | | – 7 galvanically isolated control inputs – 5 galvanically isolated control outputs – 1 RS-232 configuration interface – 1 motor power connector – 1 motor encoder connection – 1 mains connection 115/230/400 VAC | |
| Preconfigured input functions | | AUTO mode, open, close | |
| Selectable input functions | | 2nd drive profile, reduced open, reference switch, external sensors | |
| Output functions | | door referenced, door closed, door open, error, obstacle detected | |
| Housing dimensions (H × W × D) | mm | 297 × 92 × 187 | |

SMDA-400-iB Box Version

SMDA safety door drives are suitable for use in machines from a wide range of industries and can be mounted in any position. Both SMDA models are available as individual components, the SMDA-400 additionally in a box version.

The **box version** combines the drive and control unit into a single, compact component.

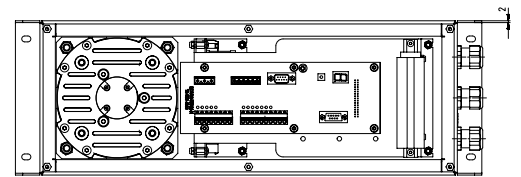
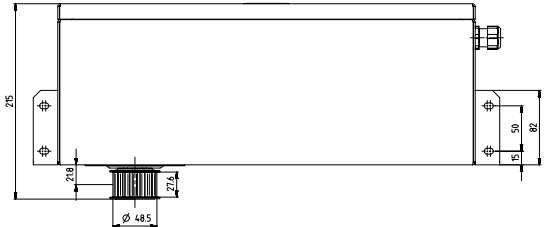
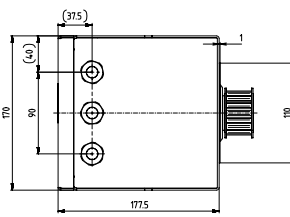
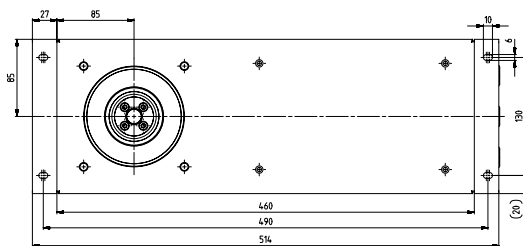

Technical Data

| Model | | SMDA-400-iB |
|---------------------------------|-------------------|---|
| Door weight | kg | ≤ 750 |
| Tensile force | N | 400 |
| Traverse path | m | ≤ 8.0 |
| Max. traverse speed | m/s | 1.0 |
| Motor data | | |
| Motor technology | | 16-pole permanent magnetic direct drive |
| Nominal motor torque | Nm | 5.4 |
| Motor pulse torque | Nm | 9.8 |
| Nominal speed at nominal torque | min ⁻¹ | 270 |
| Motor voltage | VAC | 22 |
| Control data | | |
| Max. power consumption | W | 310 |
| Mains voltage | VAC | 115/230/400 |
| Mains frequency | Hz | 50/60 |
| Ambient operating temperature | °C | + 10 ... + 40 |
| Relative humidity | % | 15 ... 85 |
| Digital I/O | VDC | 24 |
| Ports | | <ul style="list-style-type: none"> – 7 galvanically isolated control inputs – 5 galvanically isolated control outputs – 1 RS-232 configuration interface – 1 mains connection 115/230/400 VAC |
| Preconfigured input functions | | AUTO mode, open, close |
| Selectable input functions | | 2nd drive profile, reduced open, reference switch, external sensors |
| Output functions | | door referenced, door closed, door open, error, obstacle detected |
| Additional data | | |
| Mounting position | | any |
| Protection class | | IP54 |
| Housing dimensions (H × W × D) | mm | 514 × 178 × 170 |
| With drive pulley (H × W × D) | mm | 514 × 216 × 170 |
| Weight | kg | 16 |